

# Image Moments

## Digital Picture Display

### Quick Start Guide



## Getting Started with Image Moments

### Package Contents:

- ◆ Image Moments
- ◆ AC power adapter
- ◆ Remote control
- ◆ User's Guide
- ◆ Quick Start Guide
- ◆ Warranty Card

### Device Layout

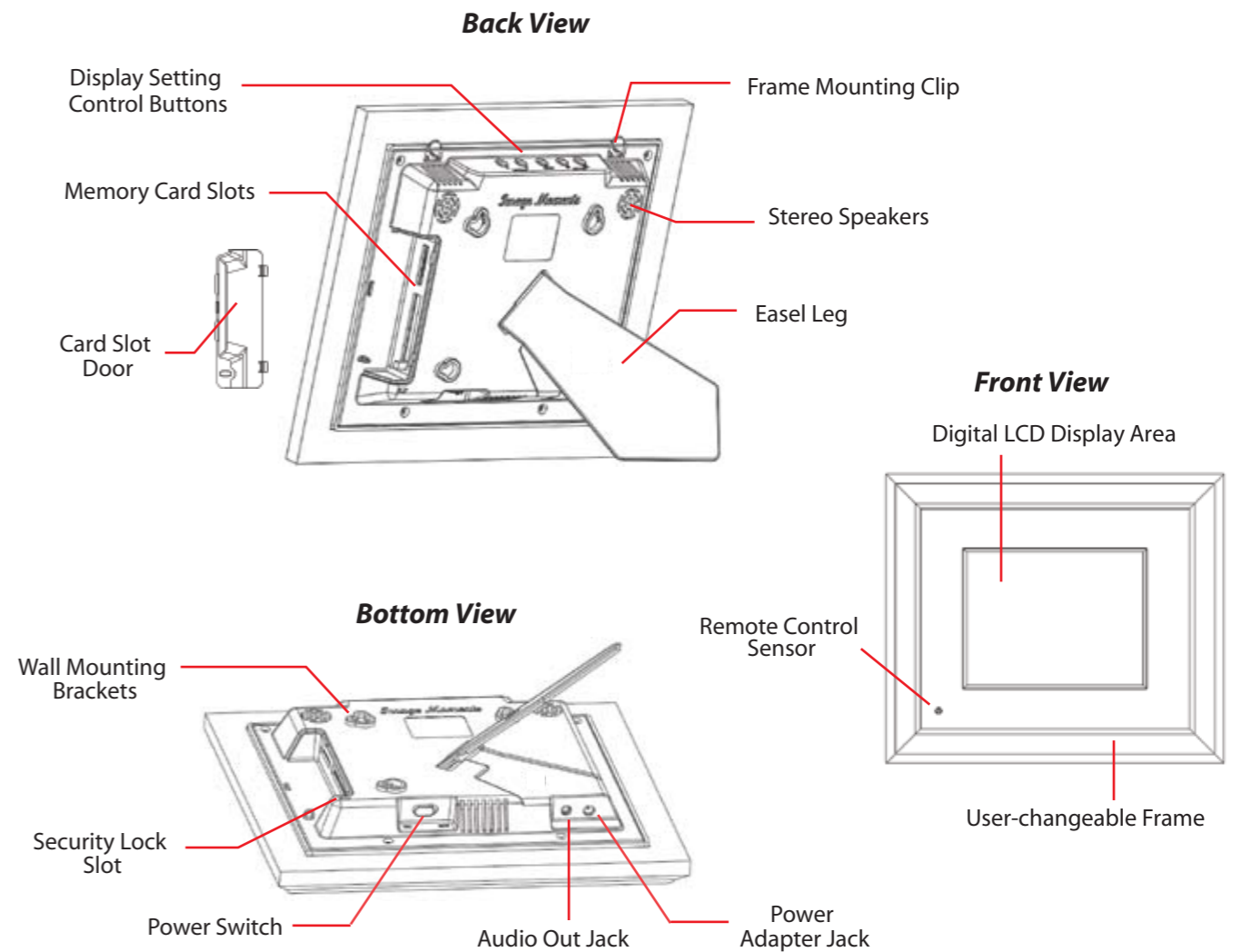

Thank you for choosing the Digital Foci Image Moments. Please use this Quick Start Guide to get started with your Image Moments.

For more detailed explanations on how to use your Image Moments, refer to the included User's Guide.

At Digital Foci, our mission is to *enhance your life by smart usage of digital technology.*

We promise to provide you:

- ◆ Easy-to-use products to help you manage and enjoy your digital content
- ◆ Attractive products to accentuate your unique style
- ◆ Education and support to help you understand the quickly changing digital technology

We aim to provide you a level of customer satisfaction that exceeds your expectations.

Let Digital Foci help *Optimize your Digital Living.*

For more information about Image Moments and other products from Digital Foci, please visit our website at:

[www.digitalfoci.com](http://www.digitalfoci.com)

Congratulations on purchasing your Image Moments - High-resolution Digital Picture Display.

Image Moments is:

- ◆ A **digital picture display** that gives you a quick and easy way to view your pictures directly from your memory card.
- ◆ A **source of joy and happiness** that helps you relive your treasured memories everyday.
- ◆ A **stylish and classy decorative piece** that looks great in any living room or office setting.
- ◆ A **mini entertainment center** that can playback your photos, videos, and music.

#### Supported Memory Card Formats:

CompactFlash, Secure Digital, MultiMedia Card, Memory Stick, MS PRO, xD-Picture Card (Standard & H-Type) (miniSD, RS-MMC, MS Duo, MS PRO Duo with adapter)

#### Supported File Formats:

- ◆ Image format: JPEG
- ◆ Video formats: MPEG-1, MPEG-2, MPEG-4
- ◆ Audio format: MP3

### Remote Control Layout

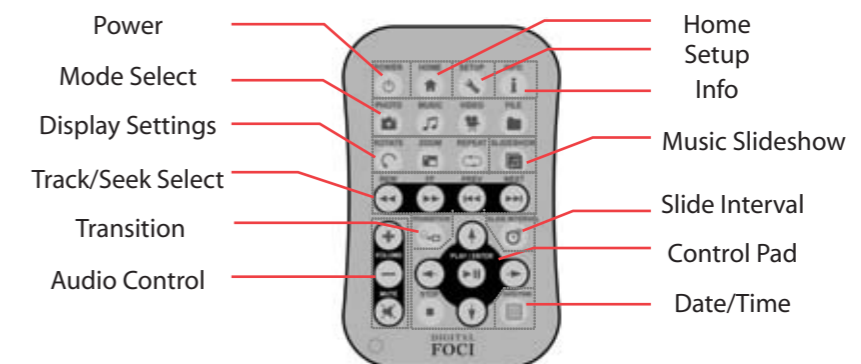

## Getting Image Moments Ready for Use

### Setting Up the Frame

Image Moments can be positioned in either landscape or portrait orientation.

To set up the frame, extend the Easel Leg by rotating it away from the device. If you would like for Image Moments to have a steeper viewing angle, adjust the Easel Leg towards the device.

### Powering Image Moments

1. Plug the power adapter into the Power Adapter Jack on the bottom-right corner under the Easel Leg of Image Moments.
2. Connect the power plug of the AC adapter to a wall socket.
3. Once power is connected, you will see the Digital Foci splash screen. If the power switch is in the **OFF** position, Image Moments will remain off after the splash screen.
4. Turn on Image Moments by sliding the Power Switch to the **ON** position. If the Power Switch is already in the **ON** position, then press the **POWER** button on the Remote Control. Or, slide the Power Switch **OFF** and then **ON** again.

**Note:** After sliding the Power Switch to the **ON** position or pressing **POWER** on the Remote Control, please wait a few seconds for Image Moments to initialize and power on.

### Preparing the Remote Control

To activate the battery, pull out the protective tab separating the battery from the battery terminal.

To operate, point the Remote Control towards the Remote Control Sensor on the front corner of Image Moments.

### Inserting Memory Cards

Before inserting your memory card, you need to remove the memory card door.

#### Removing the memory card door:

1. Place Image Moments with screen side down on a soft, flat surface that will not scratch the frame or screen.
2. With one hand keeping Image Moments still, grasp the memory card door under its handles with your other hand. Open the memory card door by gently applying pressure while rotating it up.

#### Inserting memory cards:

Insert your memory card in the designated memory card slot with the label side facing towards the back as shown below.

**Note:** To eject the CF card from the card slot, press the square black button at the bottom of the CF card slot.

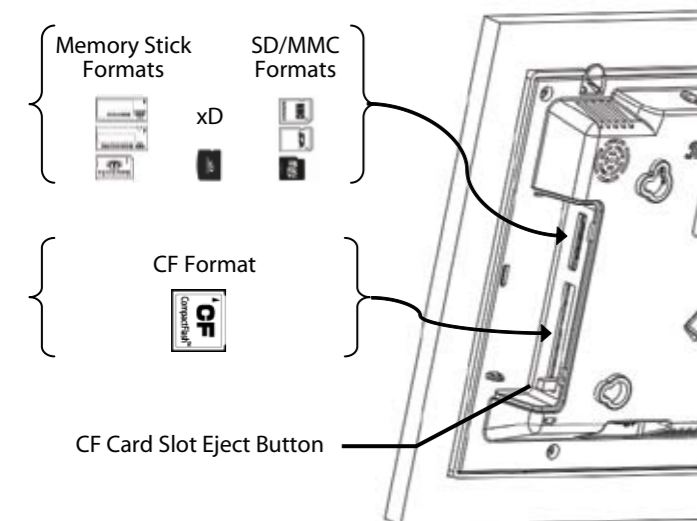

## Screen Flow Diagram

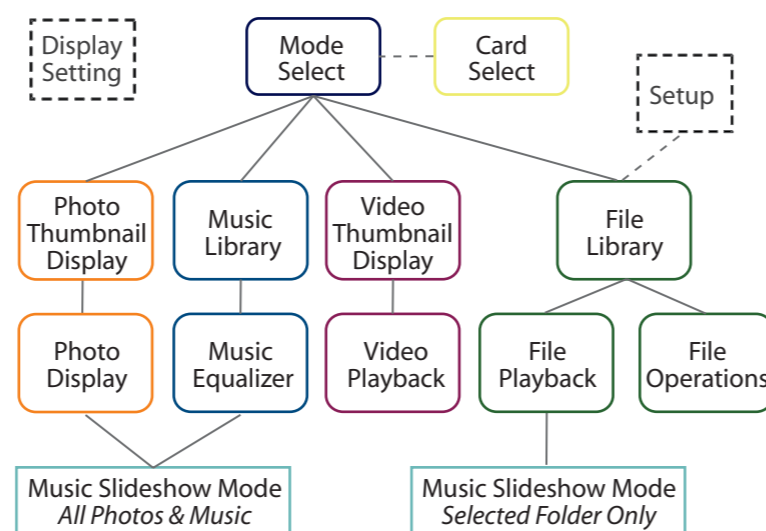

### Setting System Clock

1. Press **FILE** on the Remote Control.
  2. Press **SETUP**, and select **PREFERENCES**.
  3. Select **TIME SET > CURR TIME**.
  4. Set the correct Year, Month, Day, Hour, Minute, and Second.
  5. Navigate to and select **CONFIRM** to finalize your settings.
- Note:** The system clock on Image Moments uses a 24 hour clock. This means that instead of using AM/PM to denote morning and night, PM is designated by 13:00~24:00 hours.

### Setting Automatic On/Off Timer

1. Press **FILE** on the Remote Control.
2. Press **SETUP**, and select **PREFERENCES**.
3. Select **TIME SET > ON/OFF SET**.
4. Use the **PREV / NEXT** control to select the desired timer to set.
5. Navigate the cursor to the **On/Off Enable** field and press right/left on the Control Pad to change the setting.
6. To set the time for Auto On, navigate to each of the **On Hour** and **On Minute** fields and press right/left on the Control Pad to select the desired time.
7. Next, set the time for Auto Off. Navigate to each of the **Off Hour** and **Off Minute** fields and press right/left to select the desired time.
8. Highlight and select **CONFIRM** by pressing **PLAY/ENTER**.
8. Highlight and select **RETURN** to exit the timer setup screen.

**IMPORTANT:** After you have set the on/off timer, DO NOT use the **POWER** button on the Remote Control or the Power Switch on the main unit to turn off Image Moments. Doing so will cause the timer NOT to work. Instead let Image Moments turn off automatically according to the timer settings.

### Adjusting Volume

There are 2 volume settings on Image Moments.

1. **Base volume setting (0 ~ 100)** - this setting determines the maximum volume range for Image Moments. Adjust this setting by pressing the **Vol +** and **Vol -** buttons on the top of the device. The default setting is the maximum base volume setting of 100.
2. **In-use volume setting (0 ~ 16)** - this setting controls the actual playing volume. You can adjust this setting by pressing the **VOLUME** buttons on the Remote Control.

## Selecting Playing Mode

You can use the **PHOTO**, **MUSIC**, **VIDEO**, and **FILE** mode select buttons on the Remote Control to access each mode directly.

### Photo Mode, Music Mode, Video Mode

When **Photo**, **Music**, or **Video Mode** is selected, Image Moments will scan through the selected memory card and show only the JPEG photo files, MP3 music files, or video files.

The photo, music, or video files will be listed in alphabetical order regardless of their folder location on the memory card.

You can then browse through the files and select the desired file to play.

### File Mode

When **File Mode** is selected, Image Moments will show the **FILE LIBRARY** screen where you can navigate through the directory on the selected memory card.

As you highlight each file, a preview of the highlighted file will be displayed.

In **File Mode**, you can also access File Managements features including copy, delete, rename, and create new folder.

For example, you can use the **COPY** feature to organize your photos into distinct folders for playing back that specific set of photos. This will work for copying on the same memory card or between two inserted memory cards.

For detailed instruction on File Management features, refer to Section 4.6 ~ 4.9 in the User's Guide.

### Playing a Slideshow of All the Photos on Your Memory Card Automatically:

The default setting of Image Moments is set to **AUTO START - ON**. Simply turn on Image Moments, insert your memory card, and Image Moments will start playing your photos automatically in alphabetical order.

You can also start the slideshow manually. To do so:

1. Press **PHOTO** on the remote control.
2. Press **PLAY/ENTER** to start the slideshow.

### Playing Your Photos in Random:

1. Press **FILE** on the remote control.
  2. Press **SETUP**.
  3. Select **PHOTO SETUP**.
  4. Navigate to **RANDOM PLAY** and set it to **ON**.
- ❖ Image Moments will play your photos in random order.

### Displaying Photos:

#### Photo Thumbnail Display view:

Press **PHOTO** on the remote control to view thumbnail images of your photos.

- Use the Control Pad buttons to navigate the cursor over the thumbnails.
- Press **PREV** or **NEXT** to jump to the previous or next page.
- Press **PLAY/PAUSE** on the highlighted thumbnail to display the photo on the full screen.

#### Photo Display view:

This view displays your photos on the full screen.

- Press **PREV** or **NEXT** to navigate to the previous or next photo.
- Press **ROTATE** or **ZOOM** to rotate or zoom the photo.

### Changing Slideshow Settings:

You can change the slideshow settings on-the-fly while the slideshow is playing.

- Press **SLIDE INTERVAL** to change the timing for changing slides from 1 second up to 2 hours.
- Press **TRANSITION** to change the screen transition effect.
- Press **REPEAT** to toggle the repeat setting on and off.

### Playing a Photo Slideshow of All the Photos on Your Memory Card with Background Music:

1. Press **PHOTO** on the remote control.
  2. Press **SLIDESHOW**.
- ❖ All of the photos on your memory card will play as a slideshow and any MP3 songs on the card will play in the background.

**Note:** To add background music for the slideshow, copy your own MP3 files onto the memory card.

### Playing a Photo Slideshow of the Photos from a Specific Folder Only:

1. Press **FILE** on the remote control.
  2. Navigate to and select the desired folder.
  3. Press **PLAY/ENTER**.
- ❖ All of the photos on your memory card will play as a slideshow. If the slideshow does not advance automatically, press **PLAY/ENTER** again.

### Playing a Photo Slideshow of the Photos with Music from a Specific Folder Only:

1. Press **FILE** on the remote control.
  2. Navigate to and select the desired folder.
  3. Press **SLIDESHOW**.
- ❖ The photos contained in this selected folder will play as a slideshow along with any MP3 files located in the selected folder.
- Note:** The MP3 file you want to play in the background must be located in the selected folder. If there is no MP3 file present, nothing will play.

Read the User's Guide to learn more about operating your Image Moments:

- Adjusting Display Settings of LCD screen
- Copying, deleting, renaming files, and creating new folders
- Connecting Image Moments to external speakers
- Accessing System Setup Options
- Mounting Image Moments on the wall
- Utilizing memory card door security loop and security lock slot
- Changing outer frames
- Organizing photos on your memory cards