

Picture Porter 35

3.5" Digital Photo Manager

Quick Start Guide



Thank you for choosing Digital Foci.

Please use this Quick Start Guide to get started with your Picture Porter 35.

For more detailed explanations on how to use your Picture Porter 35, refer to the included User's Guide.

At Digital Foci, our mission is to *enhance your life by smart usage of digital technology.*

We promise to provide you:

- ♦ Easy-to-use products to help you manage and enjoy your digital content
- ♦ Attractive products to accentuate your unique style
- ♦ Education and support to help you understand the quickly changing digital technology

We aim to provide you a level of customer satisfaction that exceeds your expectations.

Let Digital Foci help *Optimize your Digital Living.*

For more information about Picture Porter 35 and other products from Digital Foci, please visit our website at:

www.digitalfoci.com

Congratulations on purchasing your Picture Porter 35 - 3.5" Digital Photo Manager.

With Picture Porter 35 you can:

- ♦ Carry your collection of digital photos, music, and videos with you and enjoy them anytime, anywhere
- ♦ Save precious vacation pictures directly from digital camera memory cards so you can free up memory card space and keep taking photos
- ♦ View photo details with zoom, pan, and rotate functions
- ♦ View EXIF information and histogram of photos
- ♦ Manage your photos directly on the device: Copy, move, delete, rename files or folders, and create new folders
- ♦ Connect Picture Porter 35 to a TV or projector for sharing photos with family and friends on a large display
- ♦ Record and playback PhotoMemo™ for specific photos
- ♦ Use Picture Porter 35 as an external hard drive for backing up your computer and transferring files between computers
- ♦ Copy files directly from Picture Porter 35 to memory cards or USB flash drive without needing a computer

System Requirements

- 1) Computer running any of the following operating systems:
 - ♦ Windows: 7, Vista, XP
 - ♦ Macintosh: OS 10.6, 10.5, 10.4
 - ♦ Linux: OS kernel versions 2.4.x & later
- 2) One available USB Port

Getting Started with Picture Porter 35

Package Contents:

- ♦ Picture Porter 35
- ♦ USB cable (to computer)
- ♦ Wrist strap
- ♦ User's Guide
- ♦ Rechargeable Polymer Li-Ion battery
- ♦ USB-OTG cable (to mass storage device)
- ♦ RCA cable for audio/video output
- ♦ Quick Start Guide
- ♦ AC power adapter
- ♦ Earphones
- ♦ Custom carrying case

Powering Picture Porter 35

Installing the Battery

Locate the battery door at the bottom right of the device. Release the door latch by pressing down on the battery door tab with your index finger. Then, use your thumb to rotate the door up and open. Insert the battery provided into the battery compartment with the arrow on the label facing up and into the battery bay. Close the door until you hear a solid click.

Charging the Battery

Connect Picture Porter 35 to the included AC power adapter to charge the battery.

The red LED will turn on to indicate that battery is charging. When battery is fully charged, the LED will turn off.

For best battery performance, charge battery to full before first use.

Powering On/Off

To turn on/off Picture Porter 35, press and hold the Power button for 3 seconds. The green LED will light up to indicate that Picture Porter 35 is powered on. If the battery is charging when the device is turned on, the LED will look orange.

Low Battery Warning

The green portion of the on-screen battery icon at the lower right corner of the screen indicates the battery life remaining. When Picture Porter 35 is low on battery, the icon will turn red and continue to decrease.

An empty battery icon means that battery is almost empty. You should supply AC power or complete your operation and turn off the device immediately. When the battery is empty, the device will stop your current task and safely turn off.

Setting the System Clock

1. Select **Setup** from the HOME screen. Highlight SYSTEM SETTINGS. Press **ENTER**.
2. Under the **Time** tab, navigate to **Time Set** and press **ENTER**.
3. The text will turn red, indicating that it can be changed. The value highlighted in yellow is the value that will change by operating the Jog Dial.
4. Roll **JOG DIAL** up/down to set the hour. Press **VAL +** to move the yellow highlight to the minute field.

Note: Picture Porter 35 uses a 24-hour clock. 12:01 AM will display as 00:01, 1:25 PM will be 13:35, and 11:59 PM is 23:59.
5. Press **ENTER** to accept your setting for the system time.
6. Next, navigate to **Date Set** and press **ENTER** to set the date.
7. In the same way, use the Jog Dial to change the current value and the **VAL +/-** buttons to change between the date fields to set the date.

Note: The date format is MM/DD/YYYY.
8. Press **ENTER** to accept your setting for the system date.

Supported Memory Card Formats & Devices

CompactFlash (CF), xD-Picture Card, SD, miniSD, SDHC, MMC, RS-MMC, Memory Stick, MS PRO, MS Duo, MS PRO Duo
With adapter*: microSD, TransFlash, MMCMobile, MicroMMC, M2
 * Adapter provided by memory card manufacturer.
With USB-OTG cable: USB Flash Drive

Supported File Formats

- ♦ Image formats: JPEG, TIFF, BMP, GIF, RAW*
 - ♦ Video formats: MPEG-4/SP, MPEG-1, MJPEG
 - ♦ Audio formats: MP3, WMA, AAC
- (* See www.digitalfoci.com/support for camera models supported.)

Device Layout



HOME Screen (Main Navigation Screen) on Picture Porter 35

Press **ENTER** on the icons to access different play modes and to navigate the default folder structure of your Picture Porter 35.

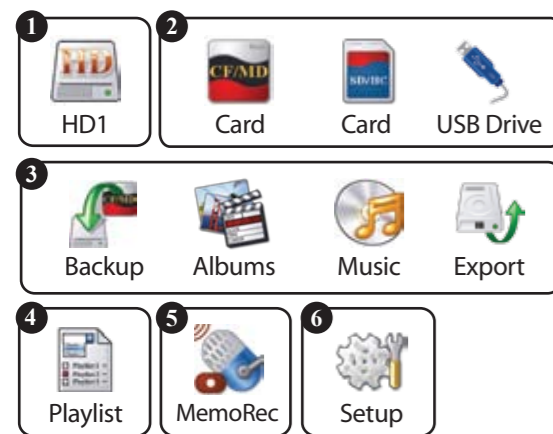

- 1 Hard Drive Access:** View, navigate, and access the contents of the Picture Porter 35 hard drive.
- 2 External Memory Source Access:** View, navigate, and access inserted memory cards or USB drive.
- 3 Shortcuts:** View and access contents of related folders on the hard drive. (See diagram to right.)
- 4 Playlist Manager:** Access and manage Playlists created on the Picture Porter 35.
- 5 PhotoMemo Recording:** Record and playback PhotoMemo associated with specific photos.
- 6 System Setup:** Access Playback Settings, System Settings, and Technical Information.

Folder Structure on Computer



Copying Photos from Card to Picture Porter 35

- Navigate to HOME screen. Insert the memory card into its designated slot with the front of the card facing up.
- A picture icon for the inserted memory card will appear along with a pop-up menu.
- From the menu, select **BACKUP to HD1** to copy the entire memory card contents to Picture Porter 35.
Note: You can also select specific files or folders to copy from the memory card to Picture Porter 35. See "Using Copy, Move, and Export Features" section for instructions.
- Picture Porter 35 will display the default folder name that will be created for the backup.
 - Select **OK** to accept the default Backup folder name that will be created and start the backup.
 - Select **Rename** to change the name of the target folder created for the copy. An on-screen keyboard will pop up, allowing you to edit the folder name.
 - Select **Folder** to do incremental backup to an existing folder. Press **VAL + / -** to change the folder selection.
- Upon copy completion, you will see the **Backup Summary**.
 - Select **View** to navigate directly to the newly created folder with the copied files.
 - Select **Confirm** to run a direct comparison of the files on Picture Porter 35 and the memory card to verify the copy.
- The created folder with the copied contents will be located within the **Backup** folder of Picture Porter 35.

The default folder names created for the backup will consist of 3 parts:

- The first 8 characters indicate the date: YY-MM-DD.
- The next few characters indicate the source memory type:
CF = CompactFlash SD = Secure Digital
MS = Memory Stick, MS Duo MMC = MultiMedia Card
MSPRO = MS PRO, MS PRO Duo xD = xD-Picture Card
USB = USB Flash Drive
- The final 2 digits, starting from '01', indicate the sequence of copies for the same date and memory type.

For example:

/ **BACKUP / 09-08-02-CF-02 /**
Date Card format 2nd folder of this format

Access Your Copied Photos on Picture Porter 35

- Navigate to and select **Backup** from HOME screen to access the photos that you copied from your memory cards. Identify each backup by its folder name. Highlight the desired folder and press **VAL +** to navigate into the folder to view the contents.

Folder View - Browse Through Folders and Files

Folder View is the first view mode you will see when browsing your Picture Porter 35 contents. In this view, you can select items for playback or file management and navigate up/down folder levels.

Navigation keys in Folder View:

- ♦ **ESC:** Return to HOME screen
- ♦ **MENU:** Show/Close Menu
- ♦ **UP/DOWN:** Move cursor
- ♦ **ENTER:** Select/De-select item
- ♦ **VAL +:** Navigate into the highlighted folder
- ♦ **VAL -:** Go back/up to previous folder level

As you move the cursor over each file, a preview image of the highlighted file will show in the preview window on the screen.

Note: If the folder was selected before entering it, all the files in the folder will be selected by default.

Index View - Review and Select Photos in a Specific Folder

From Folder View, you can press **MENU** and select **Go to Index View** to review your photos in different layouts. Next, press **MENU** and select **Index View Layout** - you can then choose to display the photos in 5x4 or 3x2 Thumbnail Views, List View, or Full Screen View.

Navigation keys in Index View - 5x4, 3x2, List View:

- ♦ **ESC:** Back to Folder View
 - ♦ **MENU:** Show/Close Menu
 - ♦ **UP/DOWN:** Move cursor
 - ♦ **ENTER:** Select/De-select item
 - ♦ **VAL + / VAL -:** Previous/next page
- Press **MENU** and select **Filter** to limit the displayed files by photo, video, or music.

To view each photo on the full screen, press **MENU**, select **Index View Layout**, and then select **Full Screen View**.

Navigation keys in Index View - Full Screen View:

- ♦ **ESC:** Back to Folder View
- ♦ **MENU:** Show/Close Menu
- ♦ **UP/DOWN:** Previous/Next Photo
- ♦ **ENTER:** Select/De-select item
- ♦ **VAL + / VAL -:** Zoom In/Out

While viewing photos full screen, you can press **MENU** and select **Slideshow Options** to change the info and metadata display.

- ♦ **Info Display:** Show or hide each of the following information items - File Counter, File Name, Time, and Date.
- ♦ **Metadata Display:** Show or hide EXIF/Histogram & IPTC comments.

Zooming Photos

When viewing photos on full screen, you can press **VAL +** to start the zoom. A 'zoom window' will appear, showing your viewing location relative to the original photo. The zoom window will disappear after 5 seconds of no activity.



While in Zoom Mode, use a combination of rolling the **JOG DIAL** up/down and pressing **ENTER** to change the Jog Dial axis direction.

Navigation keys in Zoom Mode:

- ♦ **ESC:** Cancel the zoom and return to full screen view
- ♦ **MENU:** Show/Close Menu
- ♦ **UP/DOWN:** Pan up/down or left/right
- ♦ **ENTER:** Toggle pan between up/down and left/right
- ♦ **VAL + / VAL -:** Increase/Decrease zoom level

Playing Photo Slideshow

You can start a slideshow from Folder View or Index View. Press **MENU** and select **Play Slideshow** to start playing slideshow of selected photos.

Navigation keys during Photo Slideshow:

- ♦ **ESC:** Back to previous Folder View or Index View
- ♦ **MENU:** Show/Close Menu
- ♦ **UP/DOWN:** Decrease/Increase slideshow interval (during playback) or Manually show previous/next photo (when paused)
- ♦ **ENTER:** Pause/Resume slideshow
- ♦ **VAL + / VAL -:** Adjust volume up/down (during playback) or Start Zoom Mode and adjust zoom level (when paused)

Slideshow Display Options

While viewing photos, you can press **MENU** and select **Slideshow Options** to change various slideshow settings.

- ♦ **Transition Effect:** Change the transition effects between photos.
- ♦ **Playback Sequence:** Select to play photos in listed order or random order, and change the repeat setting.
- ♦ **Background Audio:** Choose to play photo slideshow with user provided music in the background or with the user recorded PhotoMemo files.

Using Copy, Move, and Export Features

Copying and Pasting Files or Folders

You can perform Copy and Paste operation between all memory locations and devices on and connected to Picture Porter 35.

- In Folder View or Index View, navigate to and select the file(s) or folder(s) to copy. Select files and folders by pressing **ENTER** with the item highlighted. You can also press **MENU** and select **Select** for options like **Select All**, **Select Page**, and **Select Range**.
- Next, press **MENU**, select **File Management**, and select **Copy**.
- Press **ENTER** to acknowledge the copy confirmation message.
- In Folder View, navigate to the location where you want to paste the copied files or folders and select **Paste** from the menu.
- Upon completion, the screen will show the total number of files or folders pasted to the target location.

Moving Files or Folders

If you want to remove the file(s) or folder(s) from the original location, select **Move** in place **Copy** in Step 2 above.

By selecting **Move** instead of **Copy**, the items will exist only in the target location and be deleted from the original location.

Exporting Files or Folders

Another useful File Management option available to you is **Export**. This function allows you to send a copy of the selected file(s) or folder(s) to a dedicated folder called **Export**.

Each time you Export a selection, a new folder will be created within the **Export** folder in the same way that Backup works. You can quickly access the **Export** folder with the icon on the HOME screen.

Deleting, Renaming Files/Folders and Creating Folders

Deleting Files or Folders

You can delete files and folders from either Picture Porter 35 or an inserted memory card.

- In Folder View, navigate to and select the items to delete.
- Press **MENU**, select **File Management**, and select **Delete**. You can delete the highlighted file/folder, all selected files/folders on the page only, or all selected files/folders.
- At the confirmation pop-up, '**DELETE Confirmation?**' select **Yes** and press **ENTER** to confirm the deletion.

Renaming a File or Folder

- In Folder View, navigate to and highlight the item to rename.
- Press **MENU** and select **Rename**.
- An on-screen keyboard will pop up, allowing you to edit the name. Navigation for the keyboard mode are as follows:
 - ♦ **ESC:** Cancel the rename request
 - ♦ **MENU:** Delete a character
 - ♦ **UP/DOWN:** Move the cursor
 - ♦ Press **ENTER:** Select the highlighted character
 - Hold **ENTER:** Alternate between upper-case and lower-case
 - ♦ **VAL + / VAL -:** Move cursor right/left one space
- Scroll to **OK** and press **ENTER** to confirm the name change.

Creating a New Folder

- In Folder View, navigate to the location to create the new folder.
- Press **MENU** and select **Create Folder**.
- The on-screen keyboard will pop up, allowing you to create the folder name. Follow the same steps as above to create the new folder name using the keyboard.

Using Picture Porter 35 on Your Computer

Connect Picture Porter 35 to your computer with the included USB cable. Once connected to your computer, Picture Porter 35 becomes an external hard drive and memory card reader/writer.

On Windows, three devices will be displayed:

- ♦ Picture Porter 35 hard drive (with device label 'HD1')
- ♦ Two removable devices (corresponding to the supported memory card formats)

On Mac, an icon labeled 'HD1' will appear on the desktop. Icons for the memory cards will appear only when a card is inserted. You can access these devices just as you access your computer hard drive.

Take special care not to delete any of the default folders as shown in the 'Folder Structure' graphic in the HOME Screen section of this Quick Start Guide. Deleting the default folders will cause the shortcuts on the Picture Porter 35 HOME screen to malfunction.

Note: It is recommended that you use the AC power adapter when connecting Picture Porter 35 to your computer to ensure sufficient and proper power supply.

Learn More

Read the User's Guide for more detailed instructions about using your Picture Porter 35. Learn how to - Play music and videos, Display photos and videos on TV, Create and manage Playlists, Record and playback PhotoMemos, Connect to external hard drive for secondary backup, Change system settings, and much more.

Register your Product

Visit www.digitalfoci.com/registration to register your product. You will be notified about any available firmware updates and other important information about your Picture Porter 35.

Get Technical Support

Visit www.digitalfoci.com/support, contact tech support by email at: support@digitalfoci.com, or call 1-888-NOW-FOCI (669-3624).